

食品与饮料行业的应用

Food & Beverage Industries

PTFE 波纹件/隔膜/切刀垫/密封件系列
PTFE Bellows/Diaphragms/Sealings

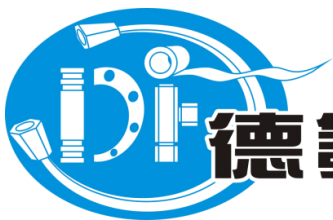

德氟

® 深圳市德诚旺科技有限公司
Shenzhen Dechengwang Technology Co., Ltd

您的PTFE解决方案专家
Your PTFE solution Expert

德诚旺-您的PTFE解决方案专家

DCW- Your PTFE solution expert

食品与饮料行业

Food & Beverage Industries

Pure, Stable, Safe

The ever-increasing PTFE demand in food and beverage industry, requires materials that guarantee PURITY AND STABILITY. This requirement translates into safety and certainty of the quality of food products for the humans, which do not only derive from the quality of the materials used but also from the production processes.

Consumer health and safety are of paramount importance in food, beverage, chemical and pharmaceutical production processes. To ensure end products intended for human consumption are as safe as possible, the material and production processes has to meet international food standard.

Dechengwang produce PTFE components for food applications such as bellows, diaphragm and seals. They can custom make according to customer specific drawings and technical requirement. We operate according to the ISO 9001 standard and complies with the latest revisions, and supported by ERP tools that allow non-compliance to be contained with the expected values and always traceability.

In production and in inspection, with the rich knowledge of PTFE material and skillful machining, equipped with a total of more than 100 machines and inspection equipment, that are able to delivery over 60,000,000 pieces PTFE parts per year. We are sure that we can offer our customers the most appropriate products, materials and solutions to meet current and future expectations.

基本前提：纯度与稳定性

重中之重：消费者健康与安全

食品和饮料行业对PTFE的需求不断增加要求材料需保证纯度和稳定性。这一要求转化为人类食品质量的安全性和确定性，不仅源于所用材料的质量，而且源于生产过程。

在食品，饮料，化学和制药生产过程中，消费者的健康和安全至关重要。为确保用于人类消费的最终产品尽可能安全，材料和生产过程都必须符合国际食品标准。

德成旺专业生产PTFE零件，许多应用于食品和饮用水行业，如波纹管，隔膜和密封件。我们可以根据客户的具体图纸和技术要求定制产品。我们根据ISO 9001质量体系运营，并遵守最新修订版的ISO标准，且有ERP系统的支持，使得不符合品得以控制在预期值内并且始终可追溯。

在生产和检验方面，有着对PTFE材料充分的了解和熟练的加工技巧，丰富的经验，并配备了100多台的机器和检测设备，使得德诚旺每年可向国内外客户提供超过6,000万件PTFE零件。我们相信，我们可以为客户提供最合适的产品，材料和解决方案，满足客户对当前和未来的期望。

- Pure 纯净
- Stable 稳定
- Safe 安全

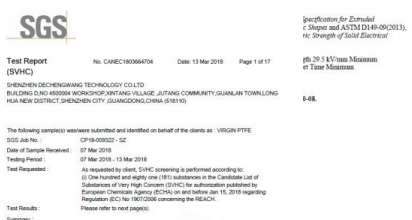

Compare of difference bellow shape

各种波纹形状设计比较

圆弧形 *Round folds bellows*



中等压力

优点: 易清洗

应用: 主要用作于计量泵, 控制阀, 截止阀以及化学, 工艺工程, 机械工程和食品工业中的灌装系统的泵元件。

Medium pressure stresses

Advantage: Easy to clean.

Application: Mainly used as pump element in metering pumps, control valves, shut-off valves and also in filling systems in chemical and process engineering, mechanical engineering and the food industry.

方角形 *Angular folds bellows*

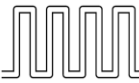

刚性强且只限于短冲程。

优势: 清洁方便, 管壁稳定, 垂直和水平安装皆可。

应用: 管道之间的应用和振动补偿面积, 使得轴和杆在侵蚀性环境中得以保护, 在流体流中也具有这样的效果。因此常用于化学, 加工工程, 各种机械工程应用, 食品以及制药行业。

High rigidity and allows only short stroke.

Advantage: Easy to clean, Stable walls and both vertically and horizontally mounted.

Application: Areas of application and vibration compensation between pipelines, protection of shafts and rods in aggressive environments and also in fluid streams. So it can be used in chemical, process engineering, mechanical engineering applications and also in the food and pharmaceutical industry.

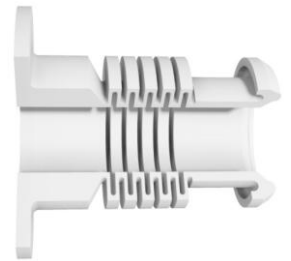

锋利角形 *Sharp folds bellows*



低压力和高冲程频率。

优点: 安装长度与弹性比良好。非常适合在动态应用中使用。

应用: 管道之间的应用和振动补偿面积, 使得轴和杆在侵蚀性环境中得以保护, 在流体流中也具有这样的效果。因此常用于化学, 加工工程, 各种机械工程应用, 食品以及制药行业。

Low-pressure stresses and high stroke frequencies.

Advantage: Good installation length to elasticity ratio. Well suited for use in dynamic applications.

Application: Areas of application and vibration compensation between pipelines, protection of shafts and rods in aggressive environments and also in fluid streams. So it can be used in chemical, process engineering, mechanical engineering applications and also in the food and pharmaceutical industry.

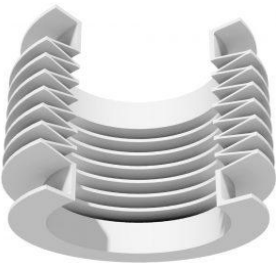

3 Bellows/3段波纹

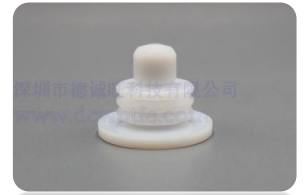
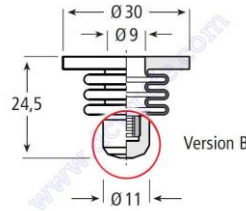

- Part No.: DGB001.03
- 型号: DGB001.03
- Material: Modified PTFE +S S
- 材质: PTFE改性料 + SS



3 Bellows/3段波纹

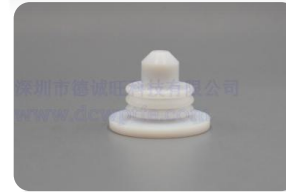
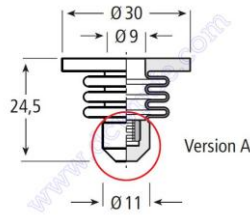

- Part No.: DGB002.03
- 型号: DGB002.03
- Material: Modified PTFE + SS
- 材质: PTFE改性料 + SS



8 Bellows/8段波纹

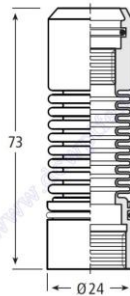

- Part No.: DGB003.08
- 型号: DGB003.08
- Material: Modified PTFE
- 材质: PTFE改性料



17 Bellows/17段波纹



- Part No.: DGB004.17
- 型号: DGB004.17
- Material: Modified PTFE + SS
- 材质: PTFE改性料 + SS



3 Bellows/3段波纹

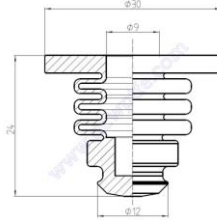

- Part No.: DGB005.03
- 型号: DGB005.03
- Material: Modified PTFE + SS
- 材质: PTFE改性料 + SS



12 Bellows/12段波纹

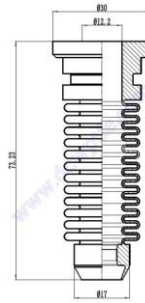

- Part No.: DGB006.12
- 型号: DGB006.12
- Material: Modified PTFE + Viton
- 材质: PTFE改性料 + 氟橡胶



8 Bellows/8段波纹

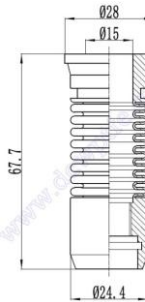

- Part No.: DGB007.08
- 型号: DGB007.08
- Material: Modified PTFE + Viton
- 材质: PTFE改性料 + 氟橡胶

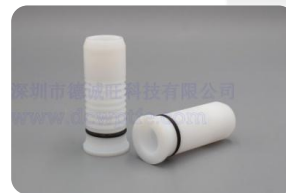

15 Bellows/15段波纹

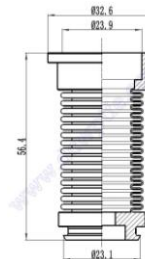

- Part No.: DGB008.15
- 型号: DGB008.15
- Material: Modified PTFE
- 材质: PTFE改性料



3 Bellows/3段波纹

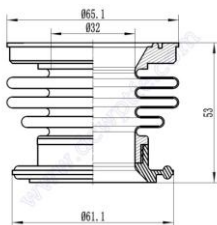

- Part No.: DGB009.03
- 型号: DGB009.03
- Material: Modified PTFE
- 材质: PTFE改性料

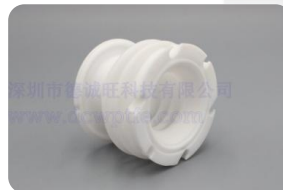

10 Bellows/10段波纹

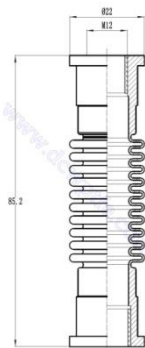

- Part No.: DGB010.10
- 型号: DGB010.10
- Material: Modified PTFE
- 材质: PTFE改性料



10 Bellows/10段波纹

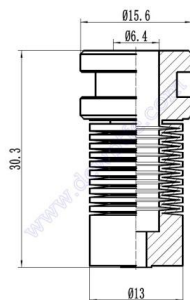

- Part No.: DGB011.10
- 型号: DGB011.10
- Material: Modified PTFE
- 材质: PTFE改性料



5 Bellows/5段波纹

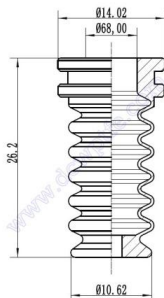

- Part No.: DGB012.05
- 型号: DGB012.05
- Material: Modified PTFE
- 材质: PTFE改性料



7 Bellows/7段波纹

- Part No.: DGB013.07
- 型号: DGB013.07
- Material: Modified PTFE
- 材质: PTFE改性料

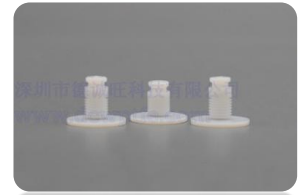
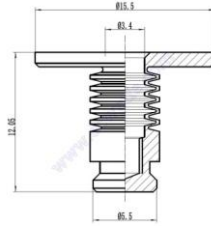

6 Bellows/6段波纹

- Part No.: DGB014.06
- 型号: DGB014.06
- Material: Modified PTFE
- 材质: PTFE改性料

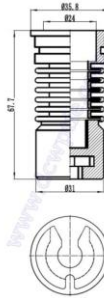

10 Bellows/10段波纹

- Part No.: DGB015.10
- 型号: DGB015.10
- Material: Modified PTFE
- 材质: PTFE改性料



Our PTFE items, are custom make for use in the food industry. Please provide samples or drawing to confirm all dimensions.

3 Bellows/3段波纹

- Part No.: DGB016.03
- 型号: DGB016.03
- Material: Modified PTFE
- 材质: PTFE改性料

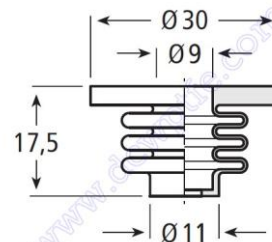

为灌装包装行业专业订做 PTFE 零件，订购时请提供样品或者图纸以核对需求尺寸。

4 Bellows/4段波纹

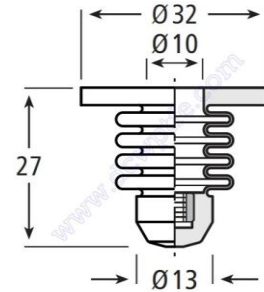

- Part No.: DGB017.04
- 型号: DGB017.04
- Material: Modified PTFE
- 材质: PTFE改性料

6 Bellows/6段波纹

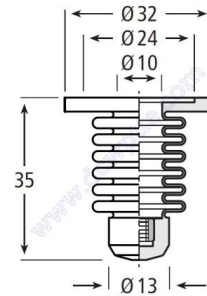

- Part No.: DGB018.06
- 型号: DGB018.06
- Material: Modified PTFE
- 材质: PTFE改性料

9 Bellows/9段波纹

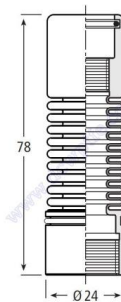

- Part No.: DGB019.09
- 型号: DGB019.09
- Material: Modified PTFE
- 材质: PTFE改性料

Our PTFE items, are custom make for use in the food industry. Please provide samples or drawing to confirm all dimensions.

10 Bellows/10段波纹

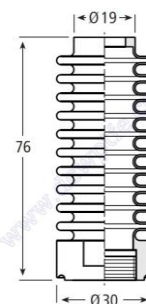

为灌装包装行业专业订做 PTFE 零件，订购时请提供样品或者图纸以核对需求尺寸。

- Part No.: DGB020.10
- 型号: DGB020.10
- Material: Modified PTFE
- 材质: PTFE改性料

12 Bellows/12段波纹

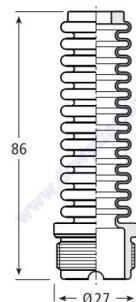

- Part No.: DGB021.12
- 型号: DGB021.12
- Material: Modified PTFE
- 材质: PTFE改性料

18 Bellows/18段波纹

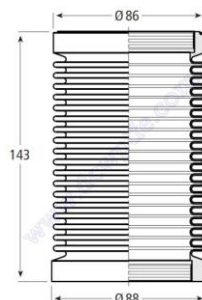

- Part No.: DGB022.18
- 型号: DGB022.18
- Material: Modified PTFE
- 材质: PTFE改性料

8 Bellows/8段波纹

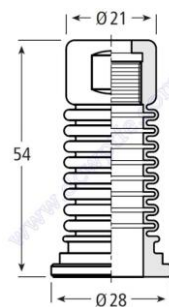

- Part No.: DGB023.08
- 型号: DGB023.08
- Material: Filler PTFE
- 材质: PTFE 填充料

Our PTFE items, are custom make for use in the food industry. Please provide samples or drawing to confirm all dimensions.

14 Bellows/14段波纹

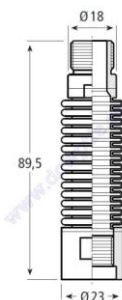

- Part No.: DGB024.14
- 型号: DGB024.14
- Material: Filler PTFE
- 材质: PTFE 填充料

为灌装包装行业专业订做 PTFE 零件，订购时请提供样品或者图纸以核对需求尺寸。

14 Bellows/14段波纹

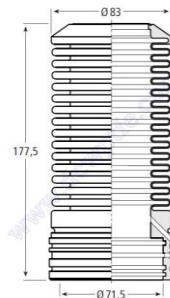

- Part No.: DGB025.14
- 型号: DGB025.14
- Material: Modified PTFE
- 材质: PTFE改性料

7 Bellows/7段波纹

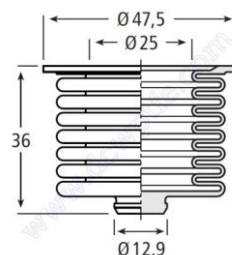

- Part No.: DGB026.07
- 型号: DGB026.07
- Material: Modified PTFE
- 材质: PTFE改性料

9 Bellows/9段波纹

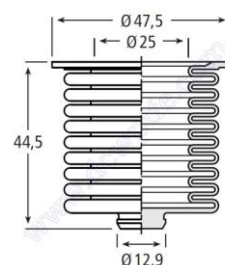

- Part No.: DGB027.09
- 型号: DGB027.09
- Material: Modified PTFE
- 材质: PTFE改性料

Our PTFE items, are custom make for use in the food industry. Please provide samples or drawing to confirm all dimensions.

6 Bellows/6段波纹

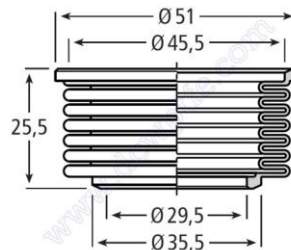

- Part No.: DGB028.06
- 型号: DGB028.06
- Material: Modified PTFE
- 材质: PTFE改性料

为灌装包装行业专业订做 PTFE 零件，订购时请提供样品或者图纸以核对需求尺寸。

7 Bellows/7段波纹

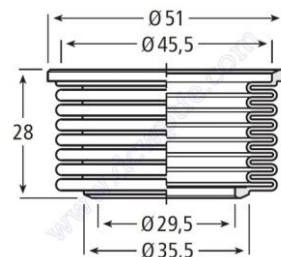

- Part No.: DGB029.07
- 型号: DGB029.07
- Material: Modified PTFE
- 材质: PTFE改性料

6 Bellows/6段波纹

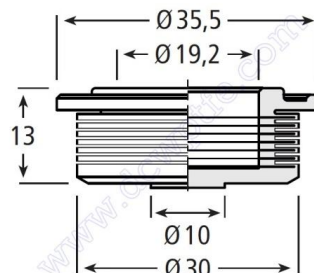

- Part No.: DGB030.06
- 型号: DGB030.06
- Material: Modified PTFE
- 材质: PTFE改性料

7 Bellows/7段波纹

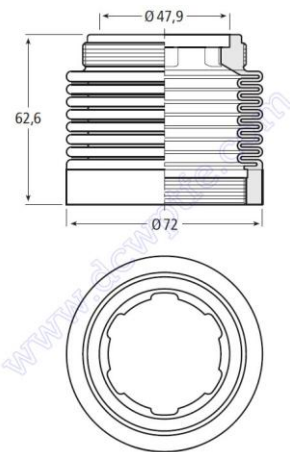

- Part No.: DGB031.07
- 型号: DGB031.07
- Material: Filler PTFE
- 材质: PTFE 填充料

Our PTFE items, are custom make for use in the food industry. Please provide samples or drawing to confirm all dimensions.

为灌装包装行业专业订做PTFE零件，订购时请提供样品或者图纸以核对需求尺寸。

Diaphragm/隔膜

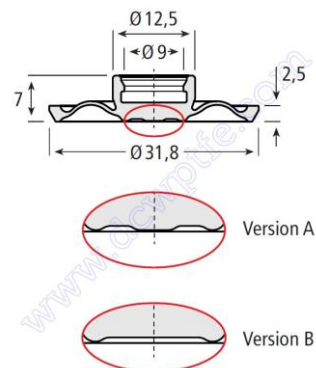

- Part No.: DGD001
- 型号: DGD001
- Material: Modified PTFE
- 材质: PTFE改性料

Diaphragm/隔膜

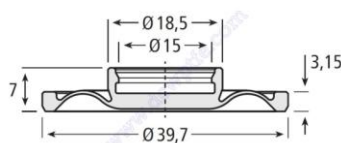

- Part No.: DGD002
- 型号: DGD002
- Material: Modified PTFE
- 材质: PTFE改性料

Our PTFE items, are custom make for use in the food industry. Please provide samples or drawing to confirm all dimensions.

Diaphragm/隔膜

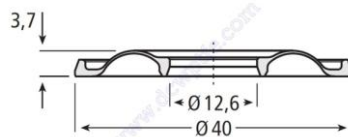

- Part No.: DGD003
- 型号: DGD003
- Material: Modified PTFE
- 材质: PTFE改性料

为灌装包装行业专业订做 PTFE 零件，订购时请提供样品或者图纸以核对需求尺寸。

Diaphragm/隔膜

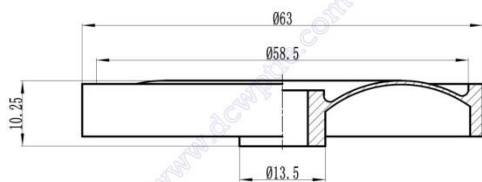

- Part No.: DGD004
- 型号: DGD004
- Material: Modified PTFE
- 材质: PTFE改性料

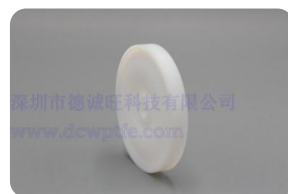

Diaphragm/隔膜

- Part No.: DGD005
- 型号: DGD005
- Material: Modified PTFE
- 材质: PTFE改性料

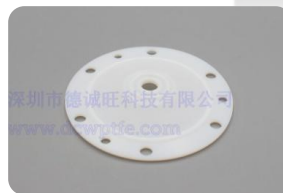
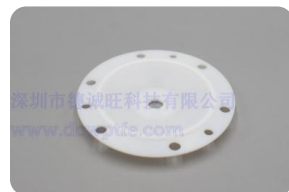
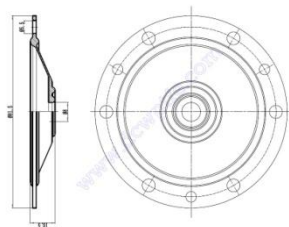

Diaphragm/隔膜

- Part No.: DGD006
- 型号: DGD006
- Material: Modified PTFE
- 材质: PTFE改性料

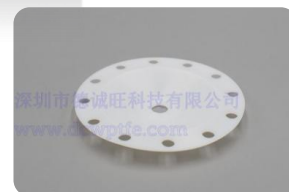
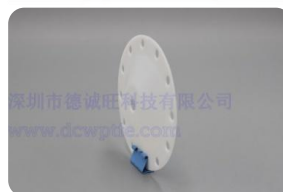
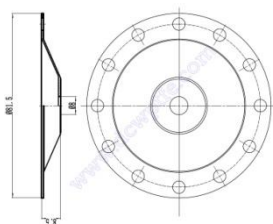

Diaphragm/隔膜

- Part No.: DGD007
- 型号: DGD007
- Material: Modified PTFE
- 材质: PTFE改性料

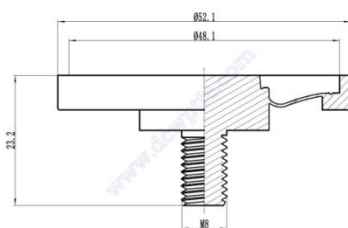

Diaphragm/隔膜

- Part No.: DGD008
- 型号: DGD008
- Material: Modified PTFE
- 材质: PTFE改性料

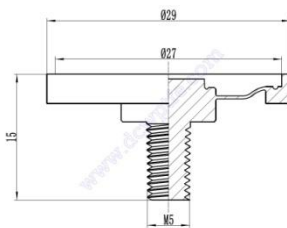

Bushing/吹嘴分流梭

- Part No.: DGQ001
- 型号: DGQ001
- Material: PEEK
- 材质: PEEK



Bushing/吹嘴分流梭

- Part No.: DGQ002
- 型号: DGQ002
- Material: PEEK
- 材质: PEEK



Cup packing with guide/带槽帽密封

- Part No.: DGQ003
- 型号: DGQ003
- Material: PTFE
- 材质: PTFE

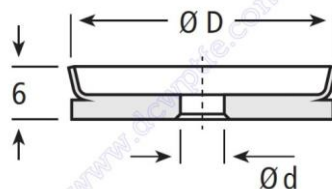

Valve cone/阀锥

- Part No.: DGQ004
- 型号: DGQ004
- Material: PTFE
- 材质: PTFE

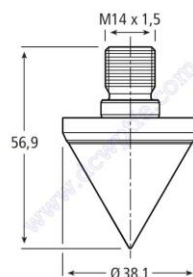

Our PTFE items, are custom make for use in the food industry. Please provide samples or drawing to confirm all dimensions.

Piston diaphragm/活塞隔膜

- Part No.: DGQ005
- 型号: DGQ005
- Material: Modified PTFE
- 材质: PTFE改性料

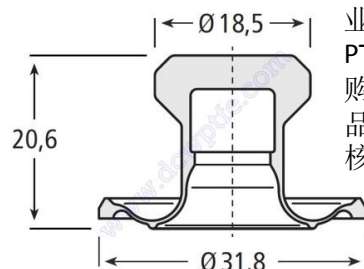

为灌装包装行业专业订做 PTFE 零件，订购时请提供样品或者图纸以核对需求尺寸。

Seal cone/锥密封

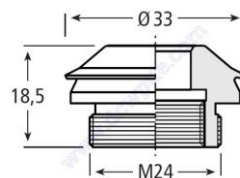

- Part No.: DGQ006
- 型号: DGQ006
- Material: PTFE
- 材质: PTFE

Seal cone/锥密封

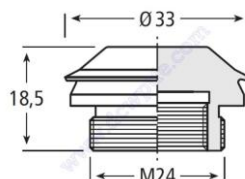

- Part No.: DGQ007
- 型号: DGQ007
- Material: PTFE
- 材质: PTFE

Seal cone/锥密封

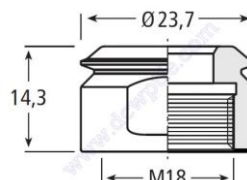

- Part No.: DGQ008
- 型号: DGQ008
- Material: PTFE
- 材质: PTFE改性料

Cup seal/帽密封

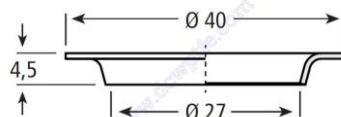

- Part No.: DGQ009
- 型号: DGQ009
- Material: PTFE
- 材质: PTFE改性料

Our PTFE items, are custom make for use in the food industry. Please provide samples or drawing to confirm all dimensions.

Wiper/刮刀

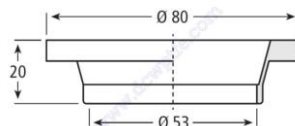

- Part No.: DGQ010
- 型号: DGQ010
- Material: PTFE
- 材质: PTFE改性料

为灌装包装行业专业订做 PTFE 零件，订购时请提供样品或者图纸以核对需求尺寸。

SLICE BLADE/成型刀盘的切刀块

The blade made from PTFE, with no clipping dough, no sticking dough and no expansion and contraction for the change of weather, can greatly solve the problems in the production process of the steamed stuffed bun molding machine.

采用PTFE材料制成的刀块，不夹面，不粘面，且不受天气变化而热胀冷缩，可大大解决包子机在生产过程中遇到的问题。

●Material: PTFE / POM / UHMW-PE

●材质：PTFE / POM /UHMW-PE

Advantage

●Low-friction, good wear plastics- which offer several benefits, including: Impact resistance, Wear resistance and Abrasion resistance.

●Chemical and stain resistant plastics - These plastics have excellent resistance to a vast range of harsh chemicals, including aggressive food products and cleaning solutions.

●High Temperature resistant – PTFE can resistance to 260 Celsius.

●Non-stick – PTFE has a natural property of non-stick.

优势

●低摩擦，耐磨的塑料 - 具有多项益处，包括：抗冲击性，耐磨性和耐磨性。

●耐化学和防污的塑料 - 这些塑料具有出色的耐受各种刺激性化学品的能力，包括腐蚀性食品和清洁解决方案。

●耐高温-其中PTFE材料可耐温至260摄氏度。

●不粘 - PTFE具有不粘的天然特性。

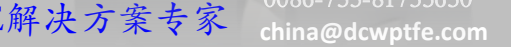
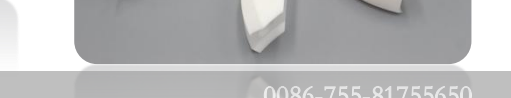
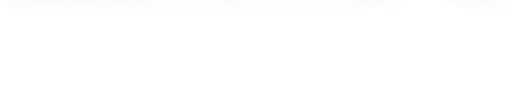
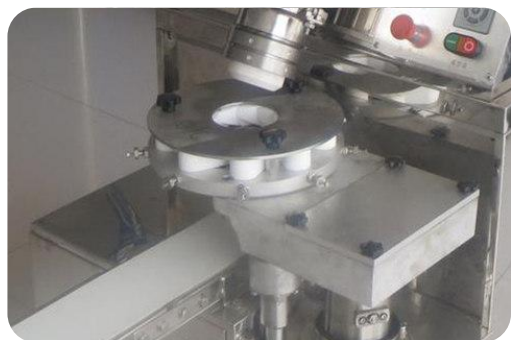

PTFE Sealing solutions/PTFE密封件

**PTFE U-PACKINGS/ V-PACKINGS**

PTFE U-packings are mostly used as a sealing in the stem of valves and pumps in food processing system.

PTFE U型 V型密封

PTFE U型 V型密封多用作食品加工行业中的阀门和泵阀杆的密封件。

**PTFE SEALS FOR PIPE CONNECTIONS**

Clamp seals and other seals for pipe connections. Pipe connections with an aseptic. Those seals have no standard size, which are custom make.

PTFE管道连接密封件

用于管道连接的夹紧密封件和其他密封件。与无菌管道连接。这些密封件是按照客户的图纸订做，没有标准件。

**Custom make PTFE Components**

Dechengwang can custom make according to customer specific drawings and technical requirement.

来图来样加工定制件

我们可以根据客户的具体图纸和技术要求定制产品



深圳市德诚旺科技有限公司
Shenzhen Dechengwang Technology Co.,Ltd

工厂地址：深圳市龙华区福城街道桔塘社区新塘村76号工业园金恒润（新塘）科技园D栋2-3楼
Address: Floor 2-3, Bld D, Jinhengrun (Xintang) Industrial Park, Xintang Village, Jutang Community, Fucheng Street, Longhua District, Shenzhen, Guangdong, China 518110.

国内业务部

联络人：姜为
手机：+86 138 2368 7940
企业QQ: 2355416364
微信：138 2368 7940
邮箱：sales4@dcwptfe.com
网址：www.dcwptfe.com

国际业务部

联络人：刘昱
手机：+86 138 2368 7546
Skype: dcwptfe-sales3
E-mail: sales3@dcwptfe.com
Web: www.ptfedf.com